

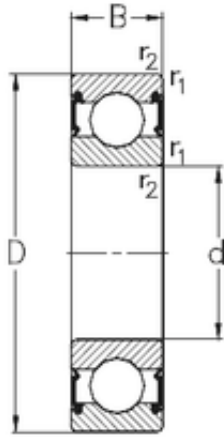

Shandong Chik Bearing Co., Ltd.



35 mm x 80 mm x 21 mm NKE 6307-RS2 deep groove ball bearings

Bearing No. 6307-RS2

Size	35x80x21 mm
Bore Diameter	35 mm
Outer Diameter	80 mm
Width	21 mm
d	35 mm
D	80 mm
B	21 mm
C	21 mm
r1 min.	1,5 mm
r2 min.	1,5 mm
Weight	0,458 Kg
Basic dynamic load rating (C)	33,4 kN
Basic static load rating (C0)	19,2 kN

6307-RS2 Bearing 2D drawings and 3D CAD models