

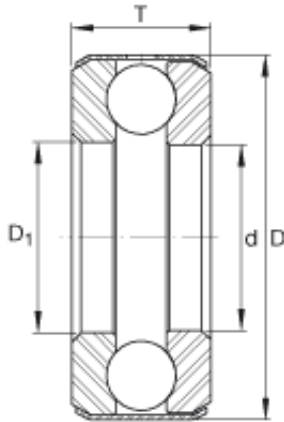

Shandong Chik Bearing Co., Ltd.



D32 Bearing 2D drawings and 3D CAD models

INA D32 thrust ball bearings

Bearing No. D32

Size	61.913x97.638x20.65 mm
Bore Diameter	61,913 mm
Outer Diameter	97,638 mm
Width	20,65 mm
d	2 7/16 inch
d	61,913 mm
D	3,844 inch
D	97,638 mm
T	0,813 inch
T	20,65 mm
D ₁	2,469 inch
m	1,19 lbs / Weight
m	538 g / Weight
C _a	11500 lbf / Dynamic load rating (axial)
C _a	51000 N / Dynamic load rating (axial)
C _{0a}	32500 lbf / Static load rating (axial)
C _{0a}	145000 N / Static load rating (axial)
Category	Thrust Ball Bearing
Inventory	0.0
Manufacturer Name	SCHAEFFLER GROUP
Minimum Buy Quantity	N/A
Weight / Kilogram	0.54
EAN	4012802034608



Shandong Chik Bearing Co., Ltd.

Product Group	B04270
Rolling Element	Ball Bearing
Thrust Bearing	Yes
Single or Double Direction	Single Direction
Banded	Yes
Precision Class	ABEC 1 ISO P0
Component Description	Roller Assembly Plus Raceways
Other Features	Single Row Deep Groove Medium Cross Section Grooved Race Non Separable Full Complement Standard Oil Hole in Band
Long Description	2-7/16" Bore 1; 2-15/32" Bore 2; 3-27/32" Outside Diameter; 13/16" Height; Ball Bearing; Single Direction; Banded; ABEC 1 ISO P0 Precision
Inch - Metric	Inch
Category	Thrust Ball Bearings
UNSPSC	31171507
Harmonized Tariff Code	8482.10.50.08
Noun	Bearing
Keyword String	Ball Thrust
Manufacturer URL	http://www.ina.com
Manufacturer Item Number	D32
Weight / LBS	1.19
Bore 2	2.469 Inch 62.713 Millimeter
Bore 1	2.438 Inch 61.925 Millimeter
Overall Height with Aligning Washer	0 Inch 0 Millimeter
Outside Diameter	3.844 Inch 97.638 Millimeter



Shandong Chik Bearing Co., Ltd.

Height	0.813 Inch 20.65 Millimeter
--------	----------------------------------