

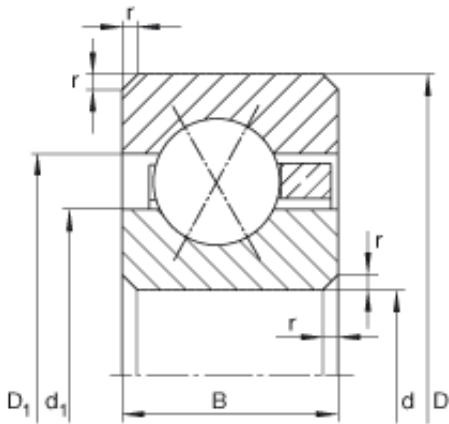

Shandong Chik Bearing Co., Ltd.



CSXA075 Bearing 2D drawings and 3D CAD models

7 1/2 inch x 203,2 mm x 6,35 mm 7 1/2 inch x 203,2 mm x 6,35 mm INA CSXA075 deep groove ball bearings

Bearing No. CSXA075

Size	190.5x203.2x6.35 mm
Bore Diameter	190,5 mm
Outer Diameter	203,2 mm
Width	6,35 mm
d	190,5 mm
d	7 1/2 inch
D	203,2 mm
B	6,35 mm
D ₁	198,5 mm
d ₁	195,2 mm
r _{min}	0,6 mm
m	0,16 kg / Weight
C _r	7000 N / Dynamic load rating (radial)
C _{0r}	16700 N / Static load rating (radial)
Category	Angular Contact Ball Bearings
Inventory	0.0
Manufacturer Name	SCHAEFFLER GROUP
Minimum Buy Quantity	N/A
Weight / Kilogram	0
EAN	4012802034318
Product Group	B04270
Enclosure	Open



Shandong Chik Bearing Co., Ltd.

Flush Ground	No
Rolling Element	Ball Bearing
Number of Rows of Balls	Single Row
Precision Class	ABEC 1 ISO P0
Maximum Capacity / Filling Slot	No
Snap Ring	No
Cage Material	Brass
Contact Angle	35 Degree 4 Point
Internal Clearance	C0-Medium
Number of Bearings	1 (Single)
Inch - Metric	Inch
Long Description	7-1/2" Bore; 8" Outside Diameter; 1/4" Width; Open; No Flush Ground; Ball Bearing; Single Row of Balls; ABEC 1 ISO P0; No Filling Slot; No Snap Ring; C0-Medium; Brass Cage; 35 Degree
Other Features	Thin Section
Category	Angular Contact Ball Bearing
UNSPSC	31171531
Harmonized Tariff Code	8482.10.50.28
Noun	Bearing
Keyword String	Angular Contact
Manufacturer URL	http://www.ina.com
Weight / LBS	0.32
Outside Diameter	8 Inch 203.2 Millimeter
Bore	7.5 Inch 190.5 Millimeter
Width	0.25 Inch 6.35 Millimeter